

# Left Hand | Long Strap Anti-Lift Hinges

**Tools required:** Pencil, No.2 Phillips screwdriver, drill and 6mm drill bit.

**Parts:**

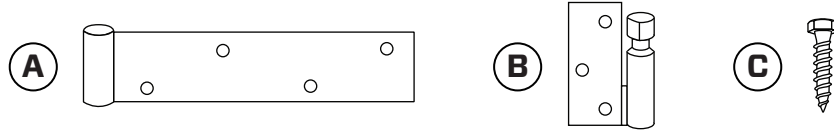

**Installation instructions:**

**STEP 1:**

Position gate in its closed position. Use wedges on each side to create a 5-10mm gap. Use wedges underneath base to set at your desired height.

**STEP 2:**

Place Part B of the hinge against post and drill 6mm pilot holes through the holes into your post and secure with coach screws using spanner. Repeat for the second hinge. When positioning the second hinge make sure it is aligned vertically with the first hinge.

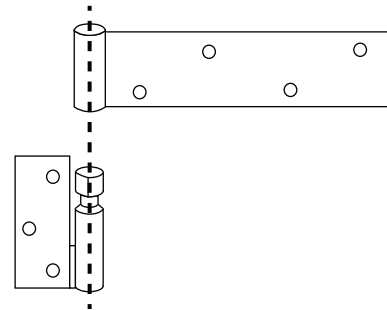

**STEP 3:**

Place Part A into Part B and drill 6mm pilot holes through the holes into your gate. Secure with coach screws using spanner. Repeat for the second hinge. Remove all the wedges.

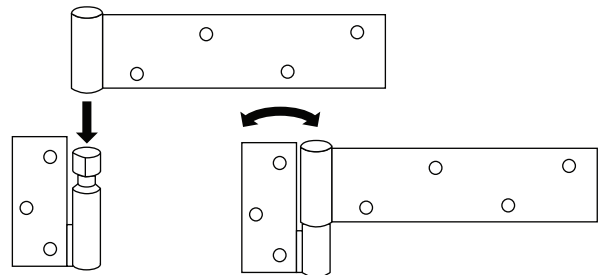

**Handy Hints:**

- Periodically apply a spray lubricant to each hinge through the hole on each hinge.
- Gate can only be lifted off if the Gate is open by at least half way.

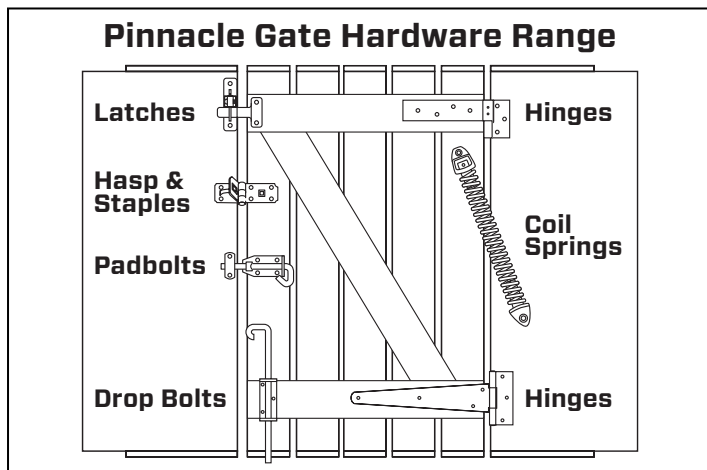

Corrosion Protection Chart		
Finish:	Rating:	
Stainless Steel	Ultimate	🛡️ 🛡️ 🛡️
Galvanised	High	🛡️ 🛡️
Zinc Plated	Moderate	🛡️

Suitable for model no: GHS003.

CONNECT WITH US!  
[PINNACLE.NET.AU](http://PINNACLE.NET.AU)

